

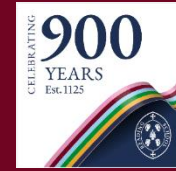

*The Reading School Year 7 Expectations Evening
will begin shortly*

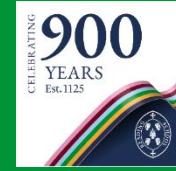

The Reading
School Year 7
Expectations
Evening
will begin
shortly



The Reading
School Year 7
Expectations
Evening
will begin
shortly



The Reading
School Year 7
Expectations
Evening
will begin
shortly



The Reading
School Year 7
Expectations
Evening
will begin
shortly



The Reading
School Year 7
Expectations
Evening
will begin
shortly

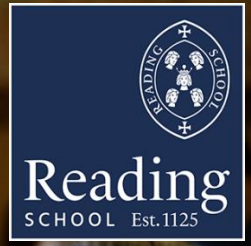
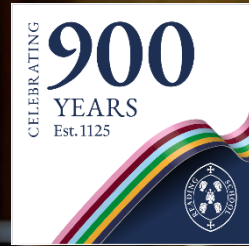

*The Reading School Year 7 Expectations Evening
will begin shortly*



Yr 7 INTEGRITY 

MORALS Principles HONEST MORALS ACCOUNTABILITY HONORABLE Rectitude Right JUST VALUE HONOR FAIR
CORE VALUES Truth STRONG FAIR UPRIGHTNESS WISE Good Character Moral Values IDEALS LIFE
Honest Truthfulness Honesty Ethical Philosophy FAITH Moral Values Ideology Live RIGHT TRUE

CELEBRATING **900**
YEARS
Est. 1125



Reading
SCHOOL Est. 1125

Expectations Evening Year 7
Date: 5 September 2024 – 7pm
Presented by Mr D McGall



Key Content:

1. The Reading Way
2. Pastoral Support
3. The Curriculum
4. Safety, Wellbeing, Happiness & Success
5. Supporting your son & working together
6. Key Dates and 900 years



1. The Reading Way



The Reading Way Timeline

KS3
Learn



Year 8

- Encourage intellectual advancement, curiosity and creativity in a stimulating, challenging but cooperative academic environment
- Junior enrichment weeks
- Elective choices and program
- Careers support for Options

Year 7

- To develop the love of learning, general study skills and team work
- Boys that Bond
- Junior enrichment weeks
- Daily elective choices and program

Year 9

- Higher Project Qualification (HPQ)
- Power to the 9's Leadership curriculum and activities
- Join Combined Cadet Forces
- Enrol on Duke of Edinburgh Scheme

Year 10

- Project Wayfinder
- Careers in Curriculum
- Senior enrichment weeks
- Community Service
- Duke of Edinburgh Scheme



KS4
Lead

Year 11

- Junior prefects
- Peer mentoring
- Community Service
- Work experience
- Careers support for A Levels

Year 12

- Future Stonas mentoring
- Student Leadership Programme(s)
- Leadership of clubs, societies and House activities
- Work experience
- UCAS & Overseas application support
- Medical Society



KS5
Serve

Year 13

- Senior Prefects and House Captains
- Medical Society
- Medical application support
- UCAS and Oxbridge Support
- Student Leadership Programme(s)
- Careers support



Old Redingensians (Alumni)

- Transition to University support
- Reading School Alumni Society
- Mentoring and support from ORs

KS3 – Learn the Way

What can I give?

- Vocabulary of character
- Virtue ethics
- Values shaping behaviours

KS4 – Lead our journeys

Where do I fit in?

- Deep conversations
- Developing an understanding of our potential
- Direction and purpose

KS5 – Serve way beyond:

What is my opportunity?

- Managing the journey
- Mastery of skills and behaviours
- Making the most of opportunities to share, contribute and serve

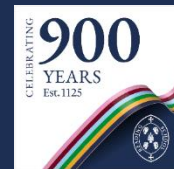

Building People of Character

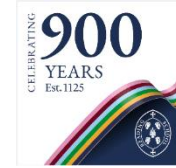

KS3 - LEARN	
EXCELLENCE	Imaginative: What is possible?
INTEGRITY	Honest: Who am I?
LEADERSHIP	Collaborative: Where do I fit in?
COMMUNITY	Receptive: What can I learn from this?



2. Pastoral Support

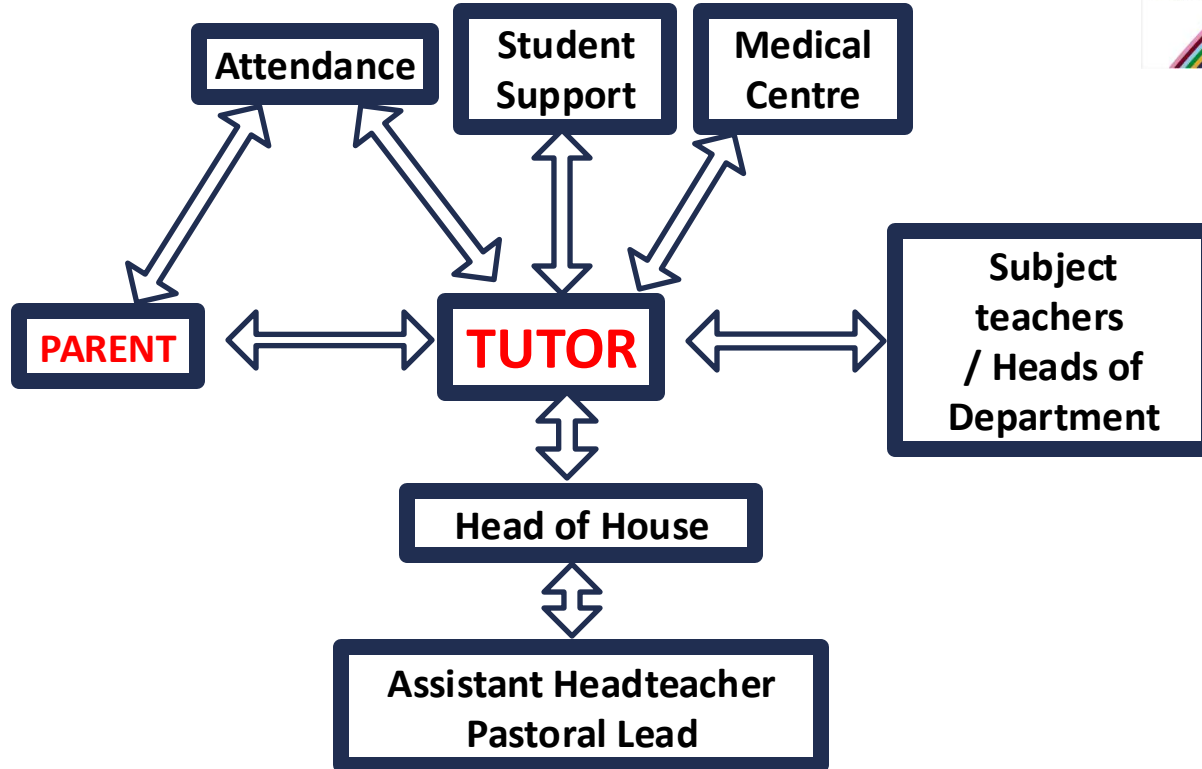
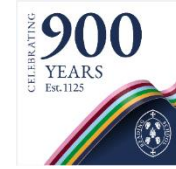

Heads of House:

Mr Tridgell	(County House)
Mr Till	
Ms Rosser-Evans	(East House)
Mr Cho	
Mrs Clarke	(Laud House)
Mr Chen	
Mr Betteridge	(School House)
Ms Steedman	
Mr Sanchez	(West House)
Mrs Maynard	

Head of Key Stage 3 & 4:

Mr McGall

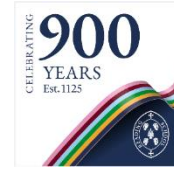

Boarding Housemasters:

Mr Lloyd

South House

Mr Sanchez

East Wing



Attendance:

Mrs Brookings

(Pastoral Manager and First Aid)

attendance@reading-school.co.uk

Other support:

Ms Ayres

(Designated Safeguarding Lead)

Ms Rogers

(SENCo)

Jas Chhokar

(Careers Advisor)

careers@reading-school.co.uk

(careers appointments)

estates@reading-school.co.uk

(lockers/bike locks)

secretary@reading-school.co.uk

(lost property & general enquiries)

safeguarding@reading-school.co.uk

(Safeguarding)



Monitoring Progress

- The student planner is key
- Parent portal
- Parents' evenings
- Grades, regular academic reporting
- Learning Support Staff
- Our reward scheme: Excellence, Integrity, Leadership, Community
- Academic Review with tutor and self reflection



3. The Curriculum

Subject

Lessons per Fortnight

• English	8
• Maths	6
• Modern Foreign Languages	6
• Biology	3
• Chemistry	3
• Physics	3
• Art	3
• Drama	3
• Music	3
• Classics	3
• Geography	3
• History	3
• Theology & Philosophy	2
• <u>Floreat</u>	2
• PSHE	1
• Electives	8

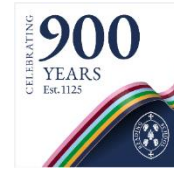

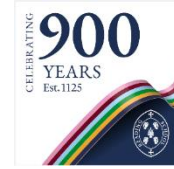

Our Goals

- **Curiosity**
- **Perseverance**
- **Reflectiveness**

Not:

- **Doing as many hours and writing as many words as possible**
 - **Being better than everyone else**

Our Year 7 & 8 Priorities

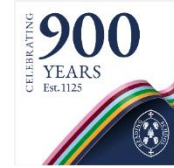

Nurturing Curiosity

Promoting supra-curricular reading

Maximising enjoyment

Ensuring collaboration

Low-stakes assessment

Subject-specific Vocabulary

Mastering Threshold concepts

Developing Practical skills

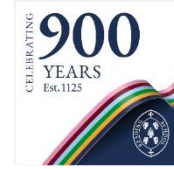

Homework

- Focus to start is on settling in
- Homework volume gradually increases after half term
- Expect 2-3 tasks each evening – guidance for staff is a maximum of one homework per two lessons in a subject
- Don't spend more than 30 minutes on a homework task
- Do expect work to be posted on Teams
- Do nurture a sense of ownership and responsibility

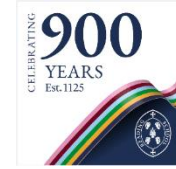

Encouraging Ownership

Year 7: Electives	4 choices per week
Year 8: Electives & Language	4 choices per week & the chance to prioritise of 2/4 MFL
Year 9: Electives, HPQ & GCSE	1 additional choice, 1 self-driven project 4/14 GCSE options
Year 10: NEA decisions	Subject specific choices (e.g. in Drama, Music, Art)
Year 11: A Level Options	Specialising in 3+ subjects
Year 12: NEA decisions	Subject specific choices (e.g. in History & Geography)
Year 13: University Choices	

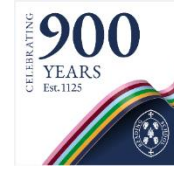

Our Results

Year 13 this summer achieved 71% A*-A

89.9% A*-B

5th Nationally Selective schools (BASS)

Creative subjects and MFL amongst our very best performers every year

Annually around 50 students are going on to read at Oxbridge, or in the USA or to study medicine or dentistry

Typically, we aim for 90% 9-7 at GCSE.



4. Safety, Wellbeing, Happiness and Success

Online Safety





Relationships

Normal issues your son will worry about:

- **Fitting in**
- **Choice of friends**
- **Being left out**
- **Feeling mature and trusted**
- **Increasingly dependent on peers for self worth**



5. Supporting your son and working together



Standards

- Attendance
- Uniform
- Behaviour
- Ready for Learning

Punctuality and absence

- Required to be in their first lesson by 8.20 am. A student is considered late if he arrives after their register is taken. This will result in a late mark being recorded in the register.



- Watch is key
- Email attendance@reading-school.co.uk or telephone from parent.
- **8:30** with details of reason and **each day of absence.**

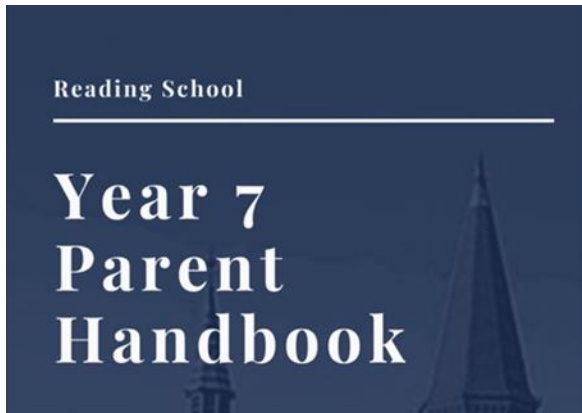

Attendance

- 95%
- Requests for planned absence must be made in writing to the Headmaster two weeks in advance. [Reading School - Absence \(reading-school.co.uk\)](https://www.reading-school.co.uk)
- Holidays, if taken during term time, will be marked as unauthorised absence.

ATTENDANCE

WHAT THE NEW RULES MEAN FOR ME

1 I'm a single parent of one child and we want to go on holiday for a week.

Your holiday will not be authorised and you must talk to the school before you book anything. Because your child will miss 5 school days you will be given a penalty notice fine. The fine is £160 but if you pay it in 21 days it will be reduced to £80.

£160



2 FOR EVERY CHILD A PENALTY IS GIVEN.



+ £160 + £160 + £160 + £160
4 children & 1 parent = £640
Reduced to £320 if paid in 21 days

IRREGULAR ATTENDANCE

10 IN 10

If your child is absent for 10 or more sessions in 10 weeks and their absences are unauthorised. The school will consider prosecution.

1 Day = **2** Sessions

3 FOR A FAMILY OF TWO PARENTS



+ £160 + £160 + £160 + £160

4 children & 2 parents =
£1280

Reduced to £640 if paid in 21 days.

If in any period of not more than 3 years, your child has a 2nd and 3rd leave of absence or pattern of irregular attendance...

4 2ND TIME

2 parents and 1 child = £320
2 children = 640
3 children = 960
4 children = 1280

No discount for early payment



3RD TIME

A penalty notice fine will not be given. Instead, your case will be taken to court.
A magistrate can fine each parent £2500 for each child
1 parent & 4 children = £10,000
2 parents & 4 children = £20,000

How Does School Attendance Affect a Child's Learning?

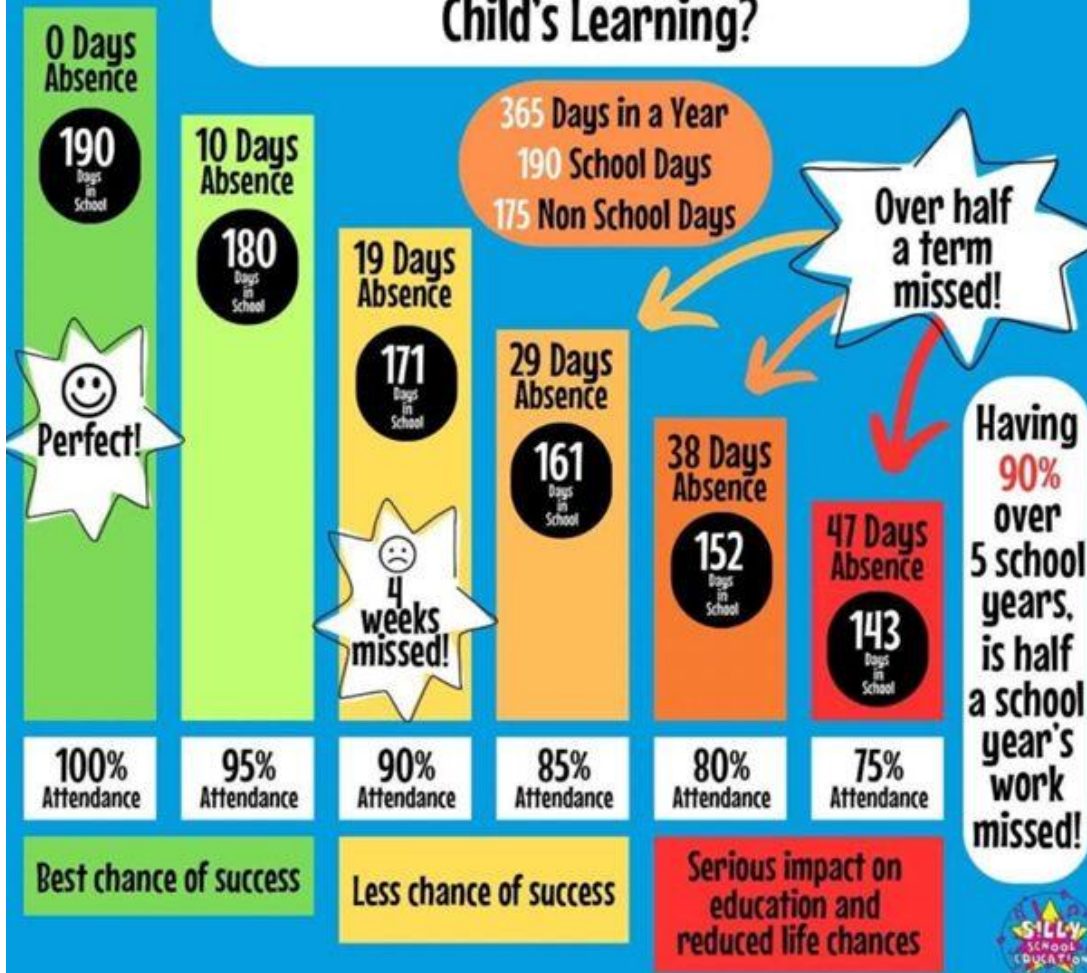



Uniform



Uniform, PE kit and changing

- Blazer, shoes and no hoodies
- Games day only* (*PE P1 can attend)
- Electives change during lunch

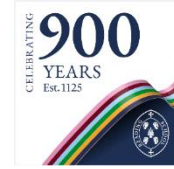

Mobile Phones and Smart watches:

Phones should be turned off on the school site for Year 7 – 11 during the school day.

Teacher can permit their usage.

Detention if you have 3 misuses during a half term





Planner and Home School Agreement

- Weekly signing
- Home school Agreement
- Equipment to ensure ready for learning

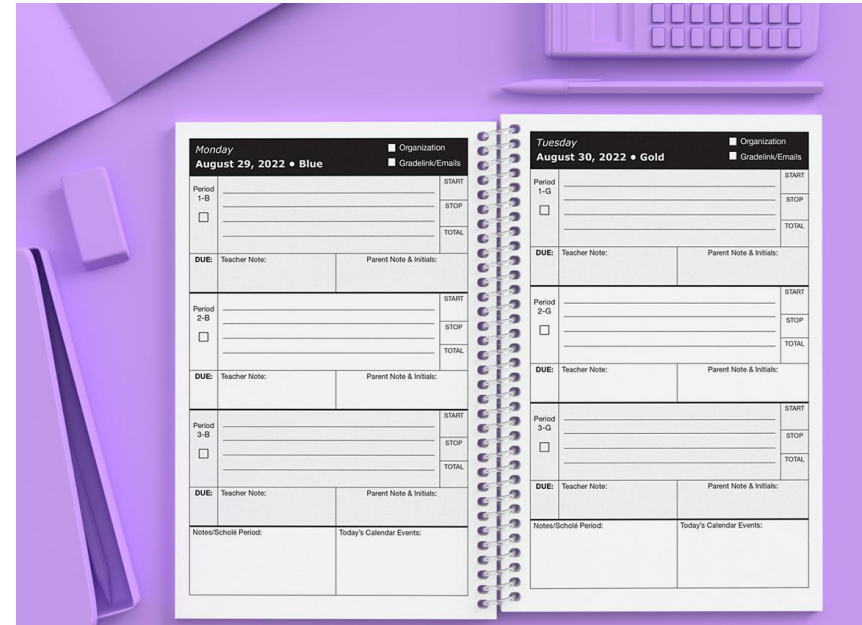

Behaviour Process– reset each half term*

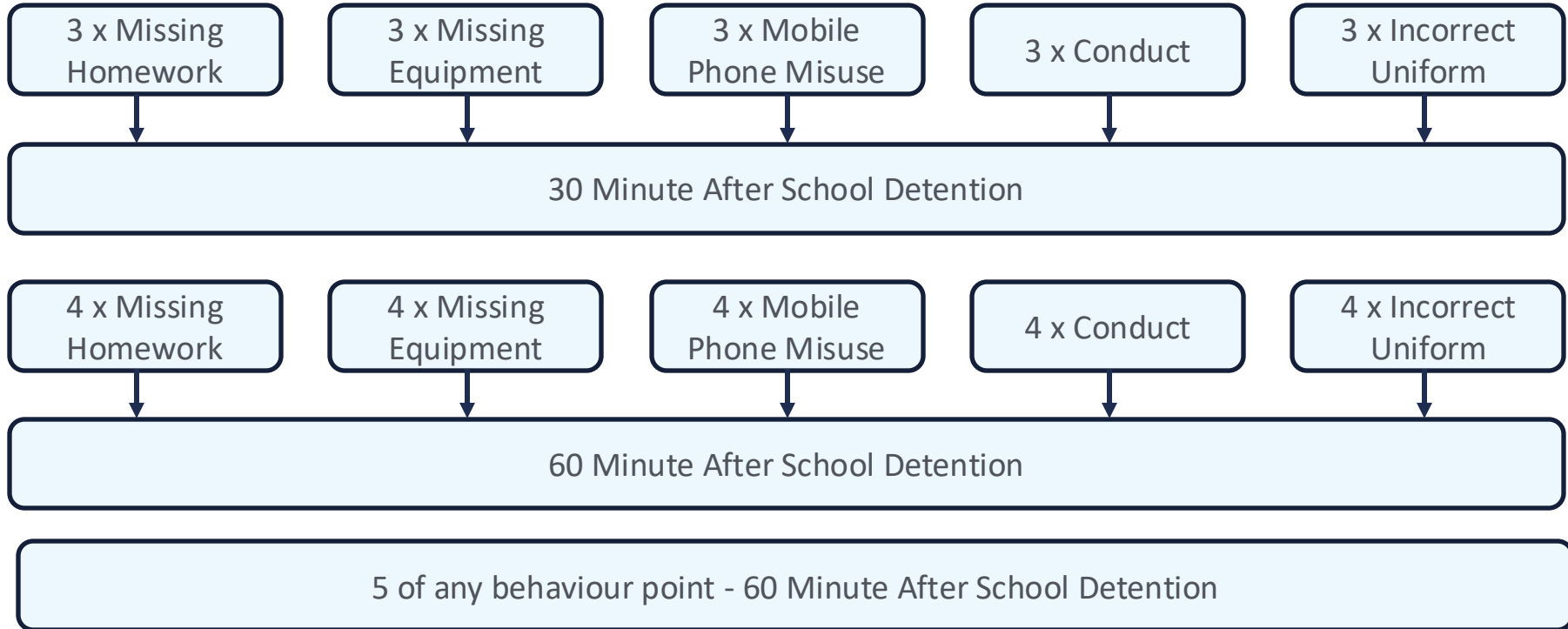

Lateness Process – reset each half term*



- 3 Lates gives leeway for the odd incident with traffic or trains.

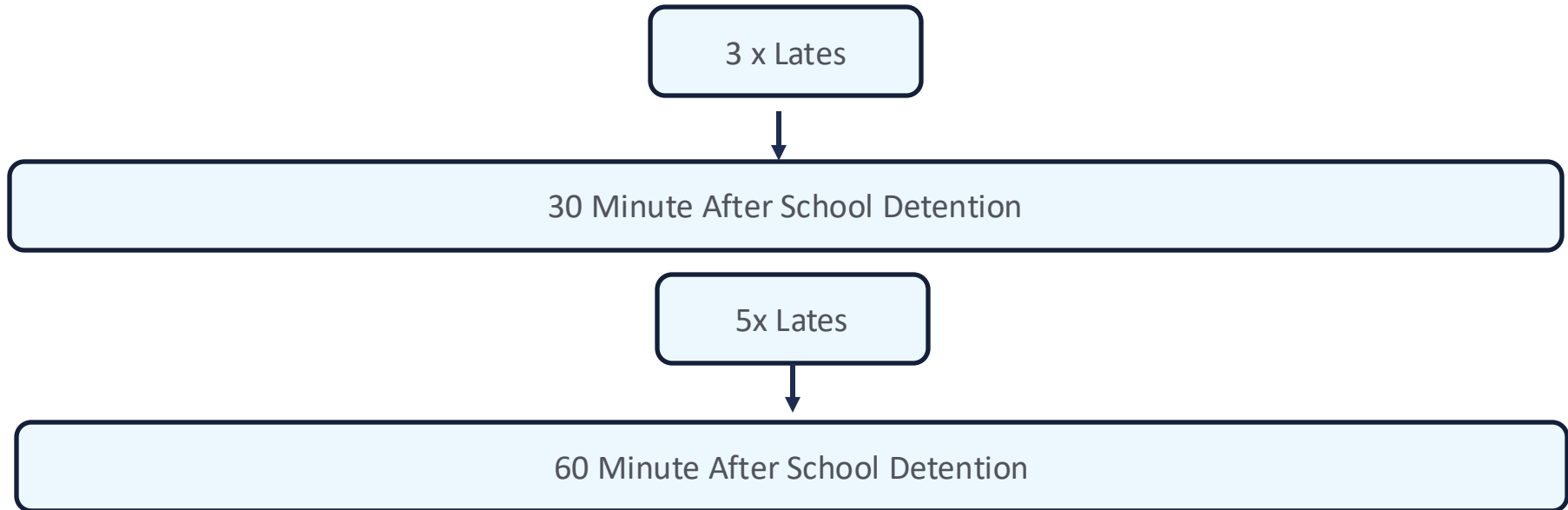

*But monitored

The Student view

I Need some Privacy

Everyone else's parents
let them...

Nobody Understands...

I just don't have any
friends...

Parental concerns

I didn't even do GCSEs – how can I help?

There is always an excuse – I don't know what to believe

He always leaves everything to the last minute and then gets stressed

He never tells us anything...



6. Key Dates

- **Thursday September 9th –**
- **Tuesday September 24th –**
- **Tuesday October 16th -**
- **Friday October 18th -**

- **Monday October 21st to Friday 25th**
- **Sunday November 20th -**
- **Monday December 9th –**

- **Thursday March 27th -**

- **w/c Monday May 19th –**

- **w/c Monday June 2nd -**

- **Monday July 1st -
Day**

- Other Year 7 specific dates for events such as term dates, reports/parents evenings, concerts, sports fixtures or house competitions are sent out in the Headmasters' Bulletin and can be found on the school website

Student Photos
New year 7 Coffee Morning
Year 7 Concert
Commemoration Service

Reading Week
House Music (Hexagon)
School Carol Service

Parents' Evening

Internal Examinations

Belonging Week
**Grandparents & Relatives
Day**



CELEBRATING

900

YEARS

Est. 1125



Celebrations

- 900th Anniversary and our Masterplan for the future

Michaelmas Term 2024

- Tuesday 8th October – 900th Anniversary Group Photo

Lent Term 2025

- Date to be confirmed - **Royal Visit**
- Monday - Tuesday 24th & 25th March – 900th Anniversary House Eisteddfod
- Thursday 27th and 28th March – **900th Anniversary Giving Day**

Summer Term 2025

- Saturday 28th June – 900th Anniversary ORA Chapel Service
- Monday 30th June till Thursday 3rd July – 900th Anniversary Drama performances
- Saturday 5th July – 900th Anniversary **Community Festival** (all welcome)
- Saturday 12th July – 900th Anniversary **Grand Reunion** (all welcome)

Michaelmas Term 2025

- Sunday 21st September – 900th Anniversary OR House Music, (Reading's Town Hall)
- Saturday 29th November - 900th Anniversary **Gala Dinner** (Reading's Town Hall)

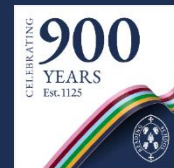

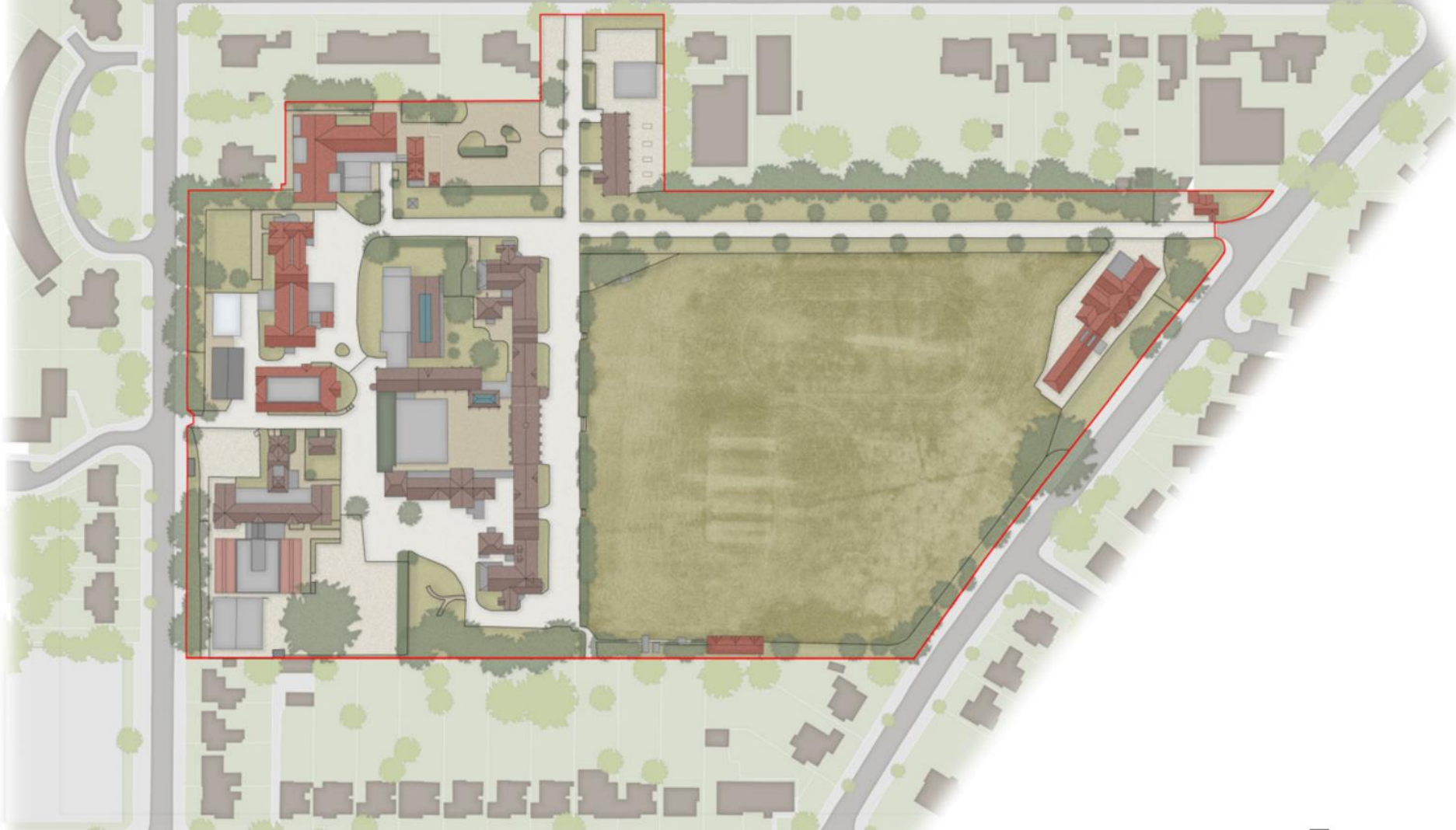



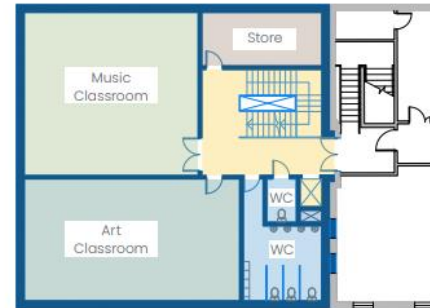
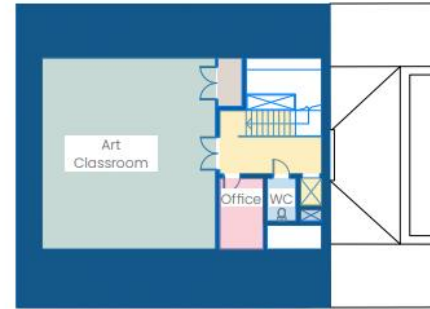
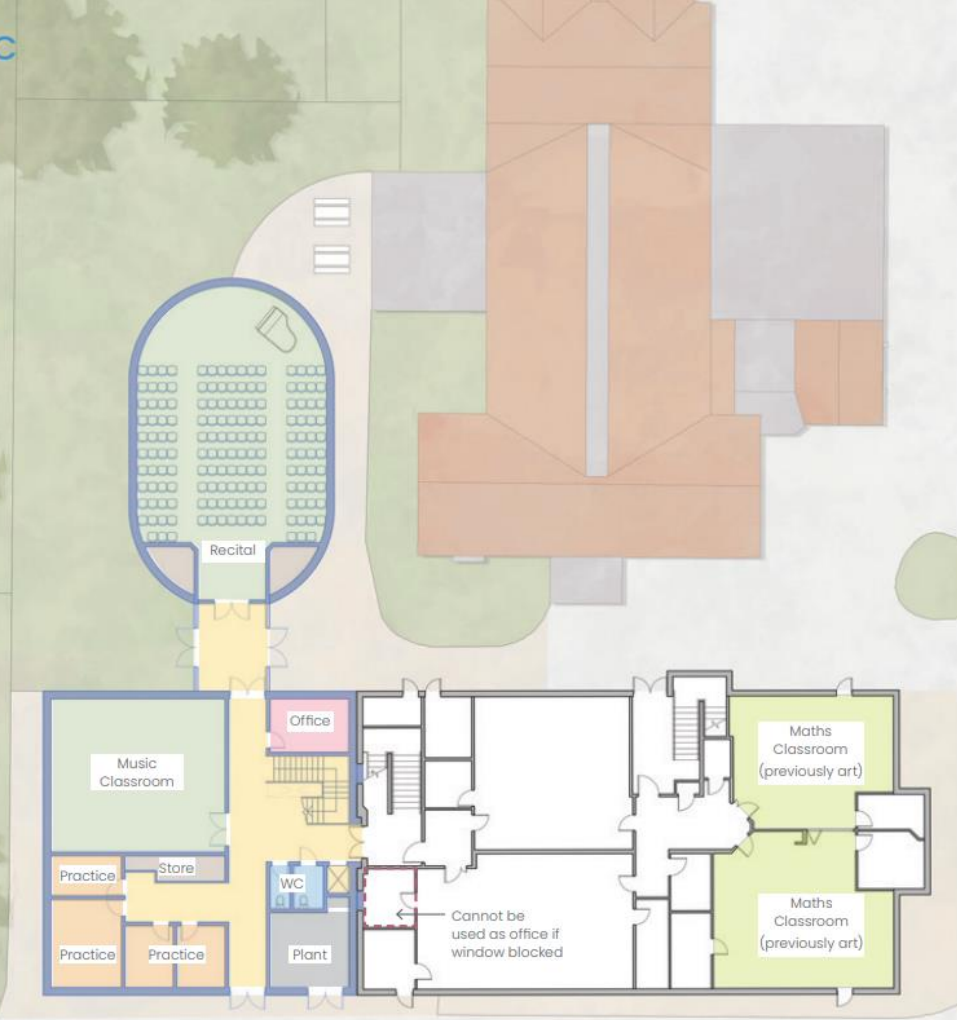

DRAMA THEATRE

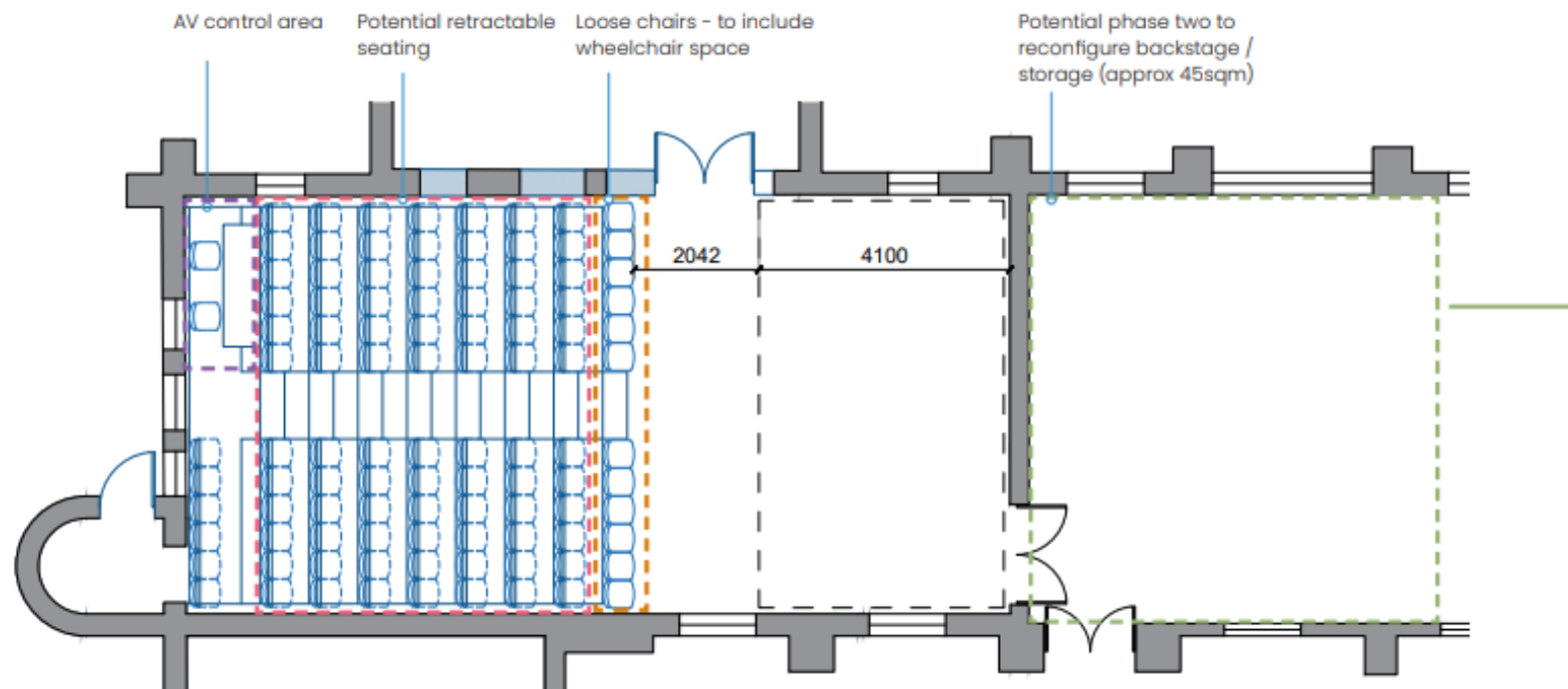

Old Gymnasium as Proposed showing new theatre space (95.4sqm)

102 seats on 850mm rows with space for AV at rear of theatre

SIXTH FORM CENTRE

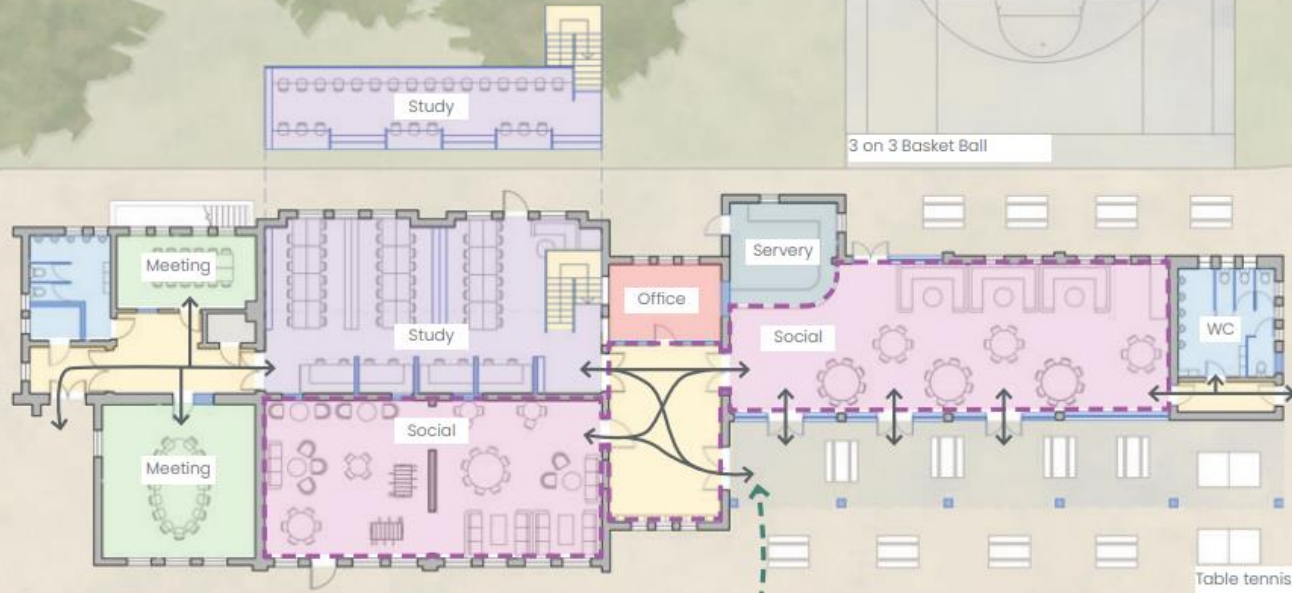

3 on 3 Basket Ball

Path via cricket pavilion to east end of terrace (approx 200m)

Possible additional path to prevent desire lines and encourage access

SWIMMING POOL

There is capacity for a 10.5m x 25m pool (5 lane) or 13m x 25m pool (recommended Sports England community swimming pool, six lane).

Requirements for changing room capacity will need assessment based on the extent of community use.



10.5m pool EW Orientation

- Changing / WC / Shower
- Reception / Staff
- Pool
- Plant

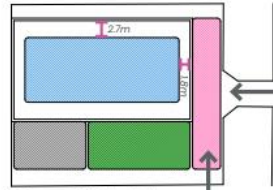

10.5m pool NS Orientation

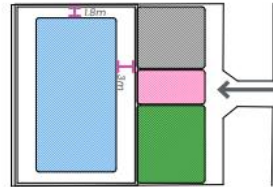

13m pool EW Orientation

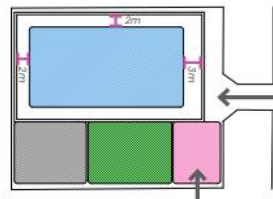

13m pool NS Orientation

Context

- Sustainability
- Biodiversity
- Heritage





Many thanks for your time